

Cabinet U-Handles

Aluminum

SPECIFICATION

Aluminum

- Powder coated
 - Black, RAL 9005, textured finish **SW**
 - UV-resistant
 - Red, RAL 3000, textured finish **RS**
 - Silver, RAL 9006, textured finish **SR**
- Anodized, natural color **EL**
- Plain finish, tumbled **BL**

INFORMATION

Cabinet U-handles GN 565.1 are manufactured from a bent aluminum profile and have excellent stability and ergonomic design. In addition to the standard surfaces, these cabinet U-handles are also available with a functional coating. The **SW** version is coated with a highly weather-resistant and UV-resistant powder coating system, making this version excellent for outdoor use.



TECHNICAL INFORMATION

- Load Rating Information (see page A35)

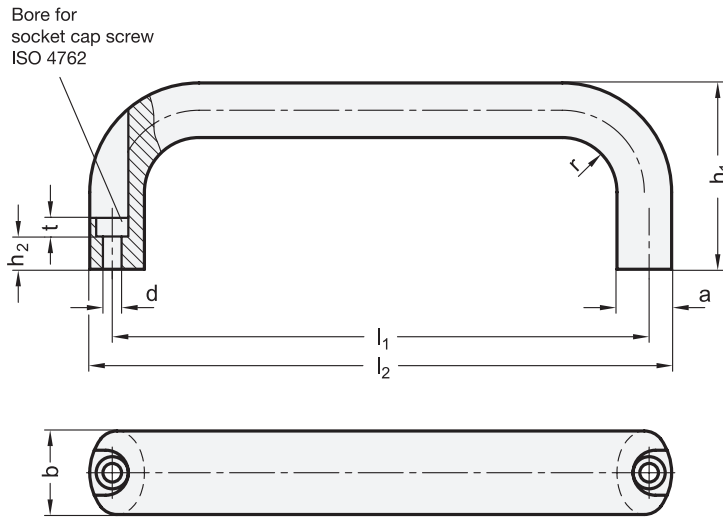

* Complete with



GN 565.1

Description	b	l ₁	a	d	h ₁	h ₂	l ₂	r	t	⚖
GN 565.1-20-100-*	20	100	13	5.4	49	13.5	112	13	5.5	76
GN 565.1-20-112-*	20	112	13	5.4	49	13.5	124	13	5.5	81
GN 565.1-20-117-*	20	117	13	5.4	49	13.5	129	13	5.5	84
GN 565.1-20-120-*	20	120	13	5.4	51	13.5	132	13	5.5	88
GN 565.1-20-128-*	20	128	13	5.4	51	13.5	140	13	5.5	91
GN 565.1-20-160-*	20	160	13	5.4	51	13.5	172	13	5.5	110
GN 565.1-26-116-*	26	116	17	6.4	55	11	130	17	6	159
GN 565.1-26-120-*	26	120	17	6.4	55	11	134	17	6	162
GN 565.1-26-132-*	26	132	17	6.4	55	11	146	17	6	165
GN 565.1-26-164-*	26	164	17	6.4	57	11	178	17	6	190
GN 565.1-26-179-*	26	179	17	6.4	57	11	193	17	6	218
GN 565.1-26-196-*	26	196	17	6.4	57	11	210	17	6	223

Weight SW